

# SUITCASE® Top Lip Extension

## RATED LOAD

- ▲ Use of the SUITCASE® Top Lip Extension (TLE) reduces overall ramp weight capacity to 500 lbs.

## INSTALLATION

1. Read and follow all instructions before use.
2. The TLE is an accessory for the EZ-ACCESS® SUITCASE® Singlefold, Singlefold AS, and Trifold® AS ramps.
3. Ensure that you have received two each of the TLE (they must be installed in pairs).
4. Open ramp (refer to ramp instructions) and insert one TLE under the top lip transition plate as shown in FIGURE 1. Rotate the TLE upward as shown in FIGURE 2. Ensure that the TLE is firmly seated in the top lip transition plate and that the square hole in the top lip transition plate is aligned with the hole in the TLE.
5. Install the carriage bolt from the topside of TLE. Secure with washer and nut on underside of TLE as shown in FIGURE 3 and tighten the nut using a 7/16" wrench. Repeat for other side of ramp.
6. When using with Trifold® ramps, install the hook and loop strap onto one TLE as shown in FIGURE 4. Fold ramp to storage position (refer to ramp instructions), then secure strap to the other TLE for transport, etc. as shown in FIGURE 5.

## WARNING!

- ▲ **DO NOT USE** ramp with TLE unless the carriage bolt and nut are secure (see FIGURE 3).
- ▲ Ensure that the top lip transition plate is secure before using. We recommend attaching the ramp temporarily to the landing using the provided clevis pins (drill 5/16" hole in landing) or semi-permanently using screws through the pre-drilled holes at the top of each section. To prevent ramp from becoming dislodged during use, make sure that the top lip transition plate overlaps the resting surface as far as possible. The surface holding the top lip transition plate needs to be substantial; make sure that the surface and supporting structure is of sound construction.
- ▲ Ensure the TLE's surface area is resting fully on the landing during use (see FIGURE 6).
- ▲ TLE is designed for use with unoccupied mobility equipment only.

## SAFETY & MAINTENANCE

Regularly check for damage and tighten any loose fasteners. Keep ramp surface clear of ice, snow, dirt, leaves and other debris at all times. Remove accumulations and sweep tread surface clean prior to use. If needed, use a damp cloth or soft brush with non-alkaloid detergent and water. Rinse well and use extra caution if ramp surface is wet.

**FIGURE 1**

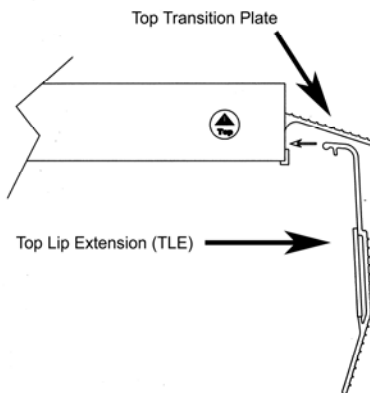

**FIGURE 2**

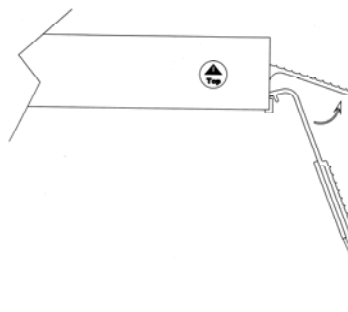

**FIGURE 3**

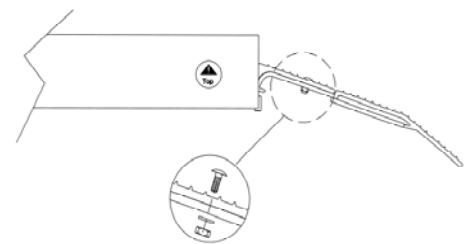

**FIGURE 4**

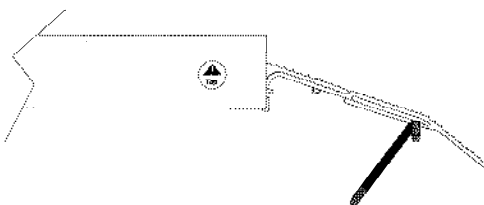

**FIGURE 5**

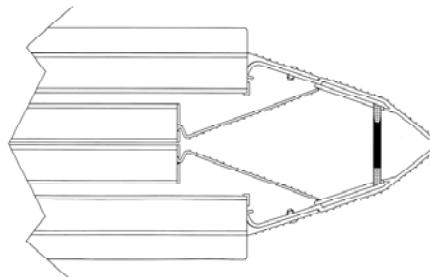

**FIGURE 6**

